



### Woodside Lane

Approximate Gross Internal Area = 647.0 sq m / 60.1 sq ft



Score	Energy rating	Current	Potential
92+	A		
81-91	B		
69-80	C	70 C	78 C
55-68	D		
39-54	E		
21-38	F		
1-20	G		

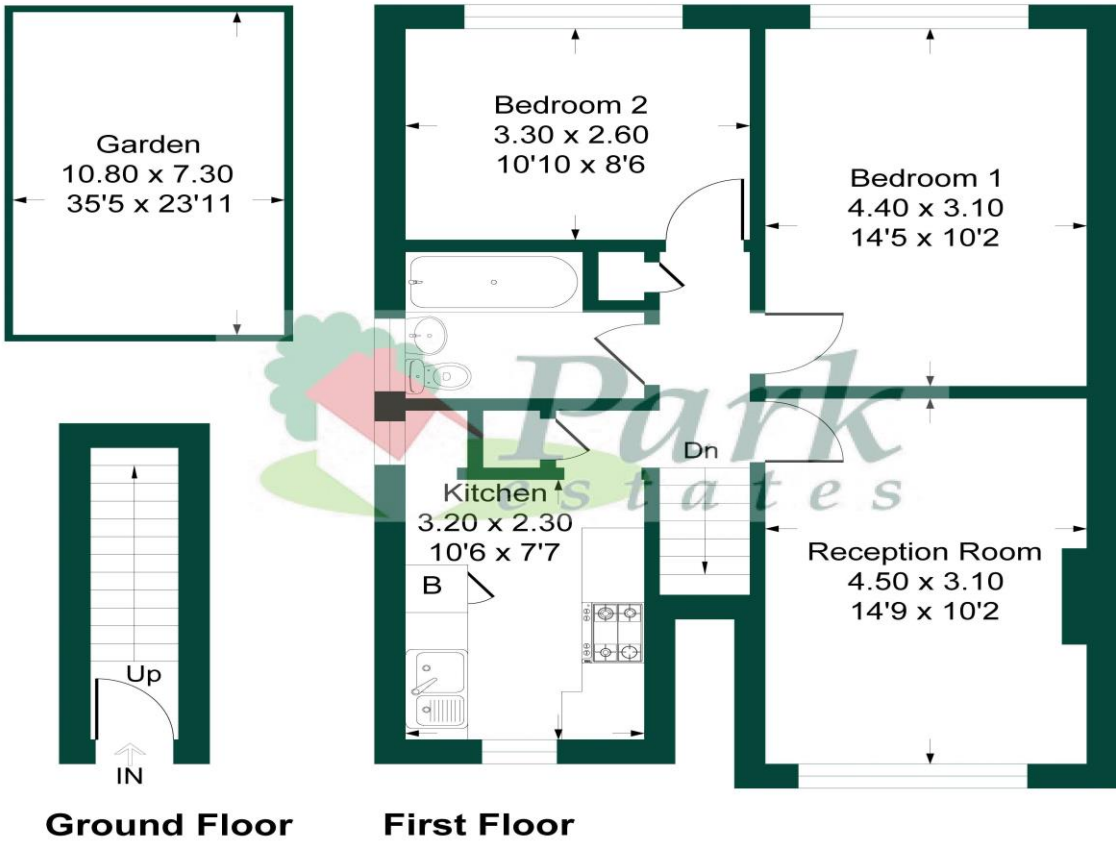

Ground Floor

First Floor

This plan is for layout guidance only. Not drawn to scale unless stated. Windows and door openings are approximate. Whilst every care is taken in the preparation of this plan, please check all dimensions, shapes and compass bearings before making any decisions reliant upon them.  
Produced By Planpix



This first floor 2 bedroom maisonette is being sold with a BRAND NEW 125 YEAR LEASE and is situated close to all amenities. An ideal first time buy or buy to let, the property has a private garden to the rear with possible off road parking. In addition the property features a living room, fitted kitchen, 2 generous bedrooms and a bathroom, as well as gas central heating, double glazing and possible off road parking to the front. Offering excellent value, your earliest viewing is highly recommended.

Lease: Brand new 125 year lease  
Ground Rent: £100 per annum. (This may Increase)  
Service Charge: £686.16 per annum  
Local Authority: Bexley  
Council Tax Band: C

